

*Leica*  
Geosystems



# DISTO™ Plan App

## Organiser and Export

- when it has to be right

*Leica*  
Geosystems

# Organiser and Export

## Organiser Overview

In **Organiser**, all the plans and sketches are stored in four categories:

- **All**
- **Projects**
- **Sketch on Photo**
- **Plans**

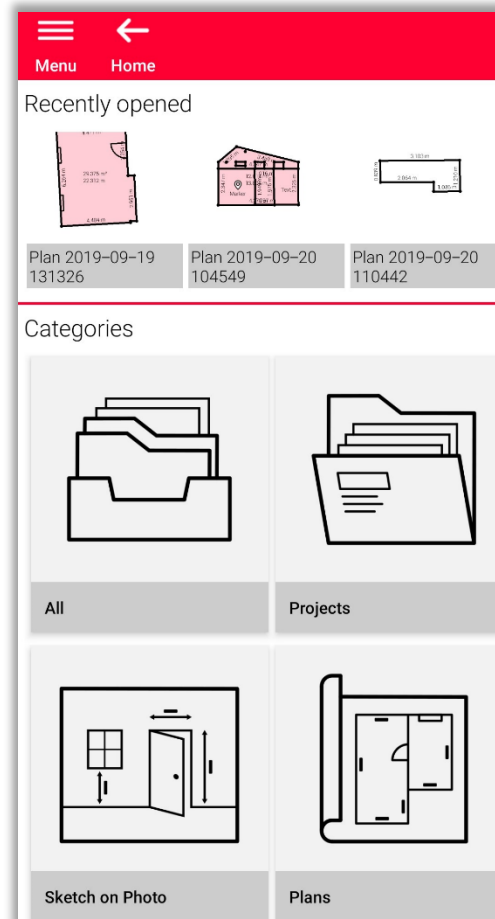

You can scroll through Recently opened files to quickly find a plan



Organiser

- when it has to be **right**

**Leica**  
Geosystems

# Organiser and Export

## Organiser - All

- In this category, all the plans, sketches and projects are listed
- You can **Sort** all objects by:
  - Date of last modification
  - Date of creation
  - Name
- You can **Select** any object on the list by:
  - Long press
  - Select button on the toolbar



You can select and deselect all object on the list anytime needed

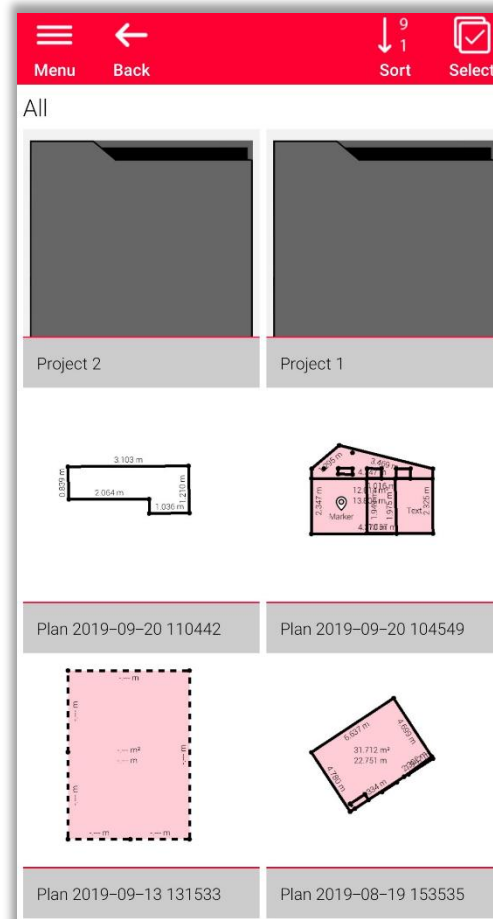

Organiser

- when it has to be right

**Leica**  
Geosystems

# Organiser and Export

## Organiser - All

Dependently on type of selected file, different actions are available:

- **Export**  
It is possible to export all selected files at once. Available formats are different for each file type

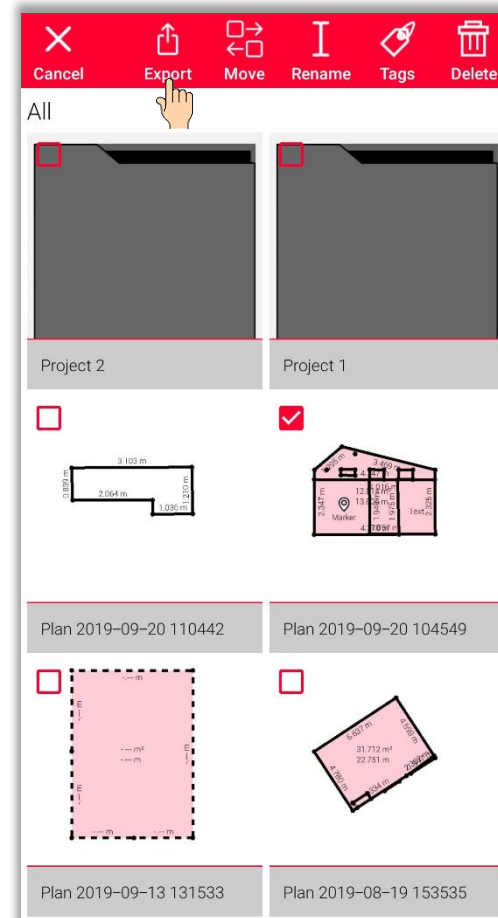

# Organiser and Export

## Organiser - All

Dependently on type of selected file, different actions are available:

- Export
- **Move to Project**  
It is possible to move all selected files to the project



You can create new project by clicking on the **“Project”** button. Selected files will be moved to the new project automatically

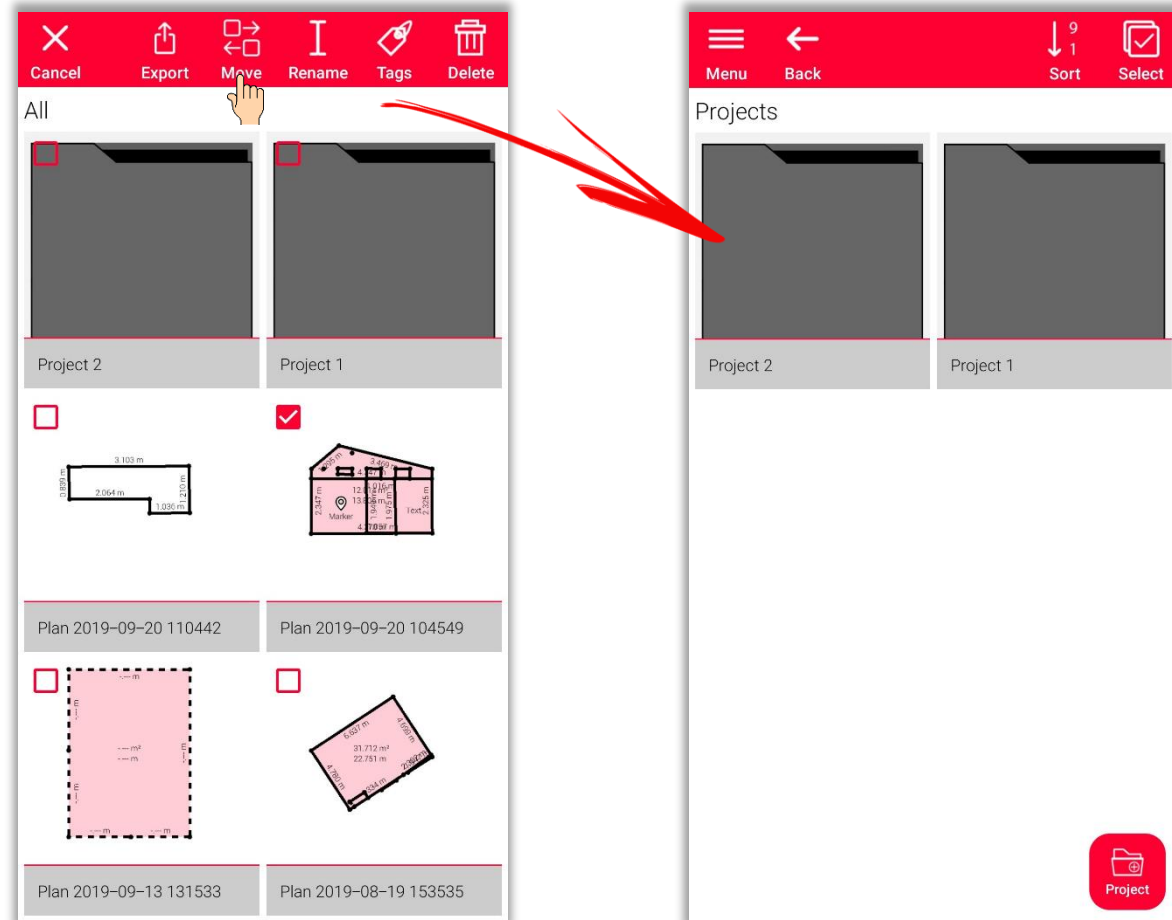

- when it has to be right

# Organiser and Export

## Organiser - All

Dependently on type of selected file, different actions are available:

- Export
- Move to Project
- **Rename**  
It is possible to change the name of any plan, sketch or project

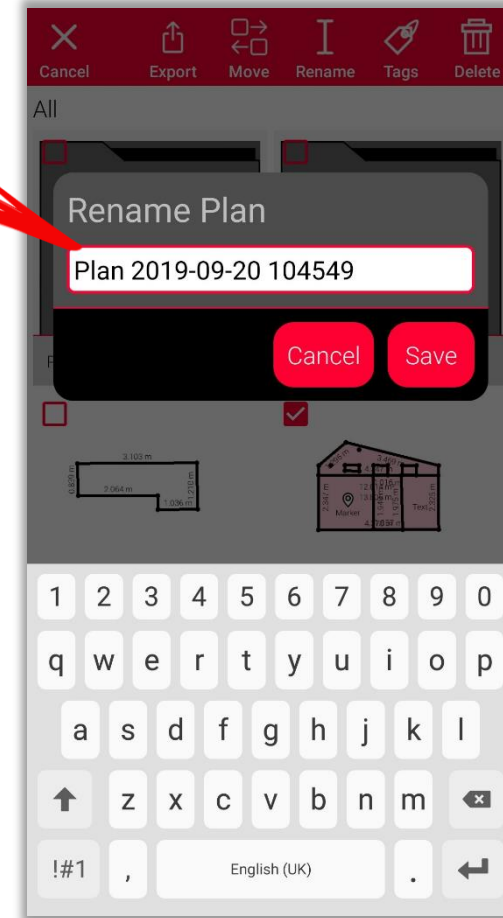
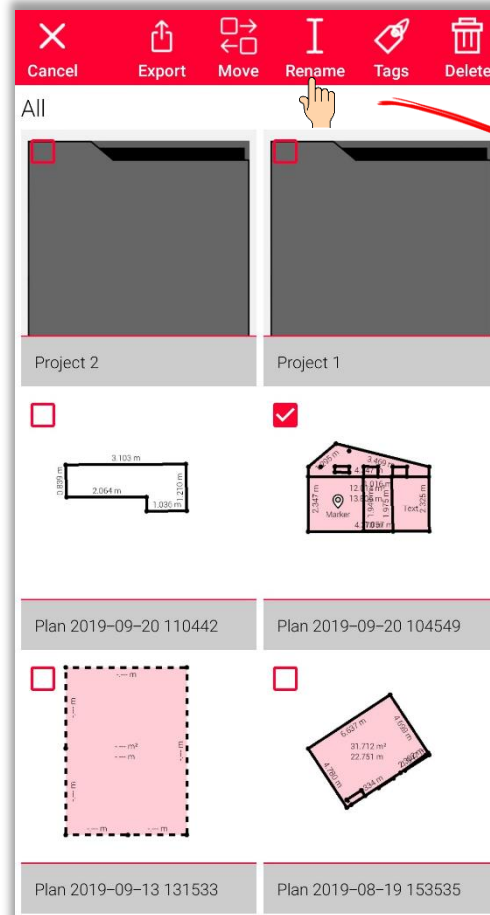

- when it has to be right

# Organiser and Export

## Organiser - All

Dependently on type of selected file, different actions are available:

- Export
- Move to Project
- Rename
- Tag  
It is possible to add tags to all selected plans, sketches or projects

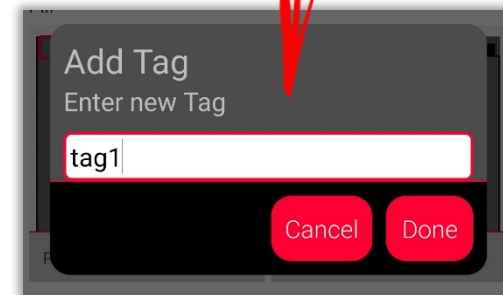
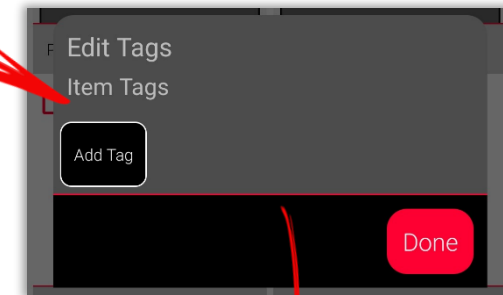
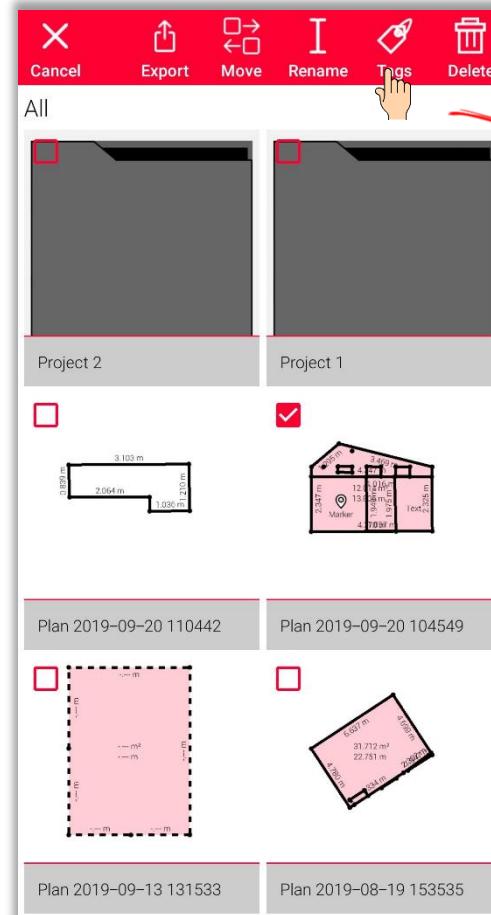

- when it has to be right

# Organiser and Export

## Organiser - All

Dependently on type of selected file, different actions are available:

- Export
- Move to Project
- Rename
- Tag
- **Delete**  
It is possible to delete all selected plans, sketches and projects

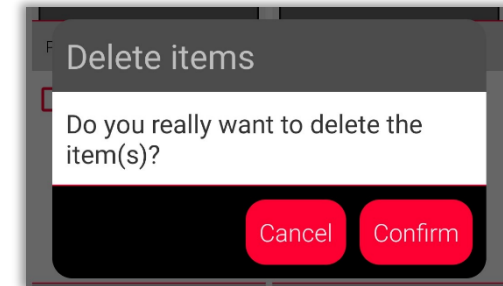
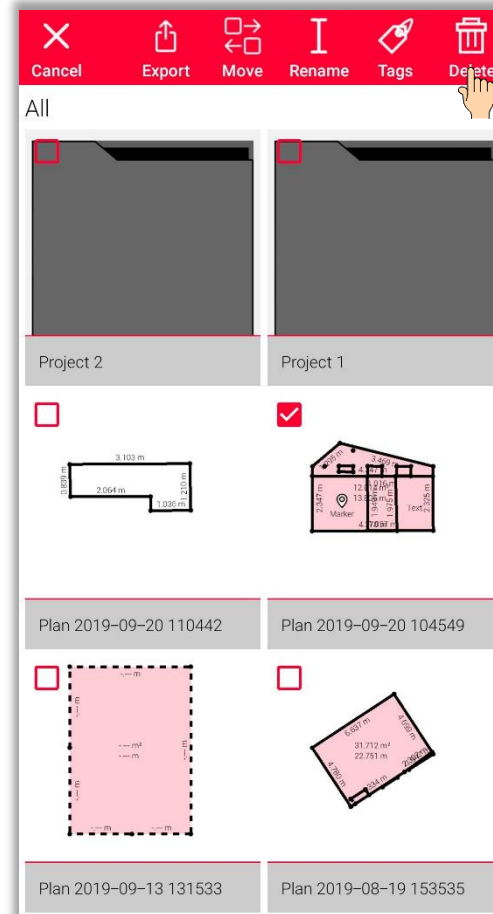

- when it has to be right



# Organiser and Export

## Organiser - Projects

- In category “**Project**” all projects are listed
- It is possible to create a new project using “**Project**” button
- All sketches can be moved into project folders
- It is possible to create a new sketch directly in the new project

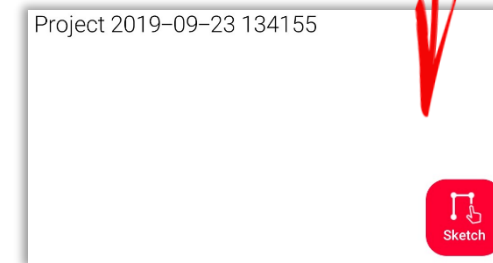
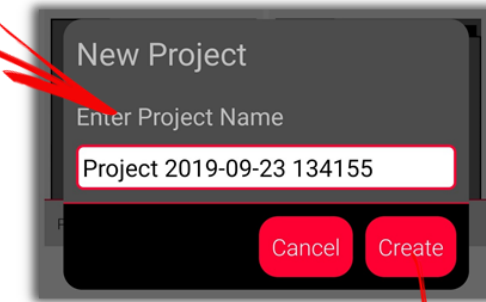
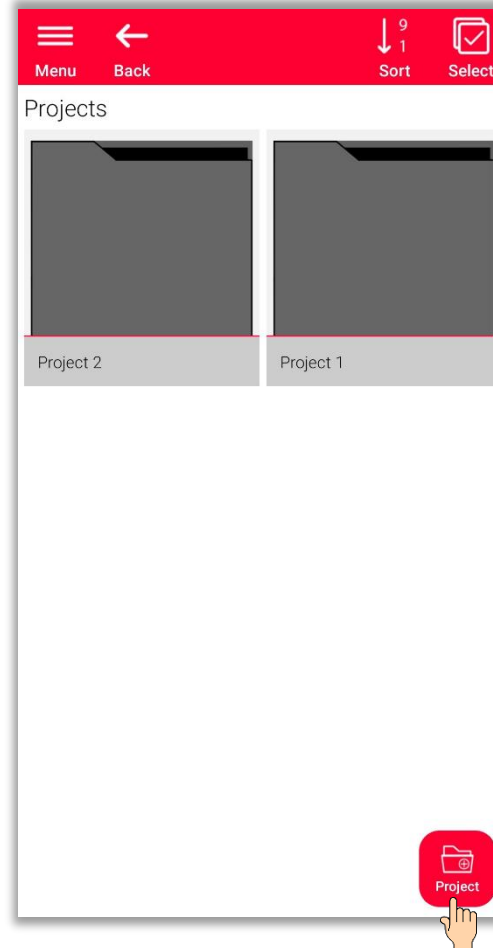

- when it has to be right

# Organiser and Export

## Organiser – Sketch on Photo

- Open the category “**Sketch on Photo**”, where all the **Sketch on Photo** sketches are stored
- Press “**New**” button to create a new Sketch on Photo sketch using camera or file from the gallery

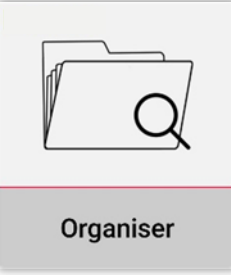
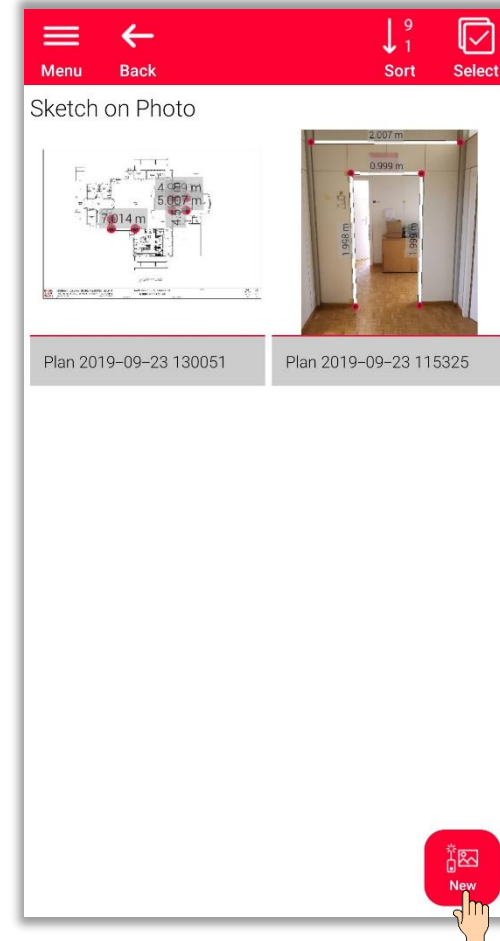

# Organiser and Export

## Organiser – Plans

■ In “Plans” category all plans created with:

- Sketch Plan
- Smart Room
- Measure Plan
- Measure Façade
- Earthworks
- Measure 3D

are listed

■ Press “Sketch” button to create a new plan

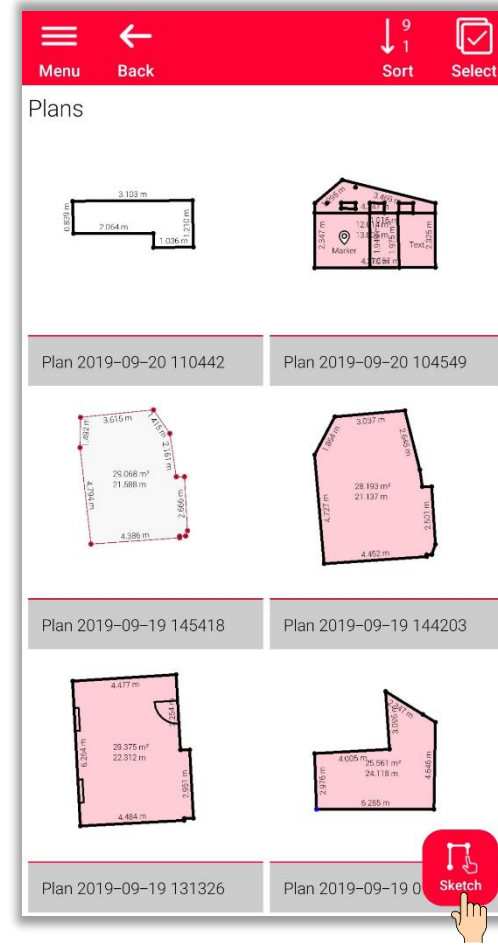

- when it has to be right

# Organiser and Export

## Organiser – Export

- To **export** a file, simply press and hold your finger over the file
- The option to **export**, is shown on top bar of the display
- An **export** can be made from various different folders (e.g. All, Projects, Sketch on Photo, Plans)

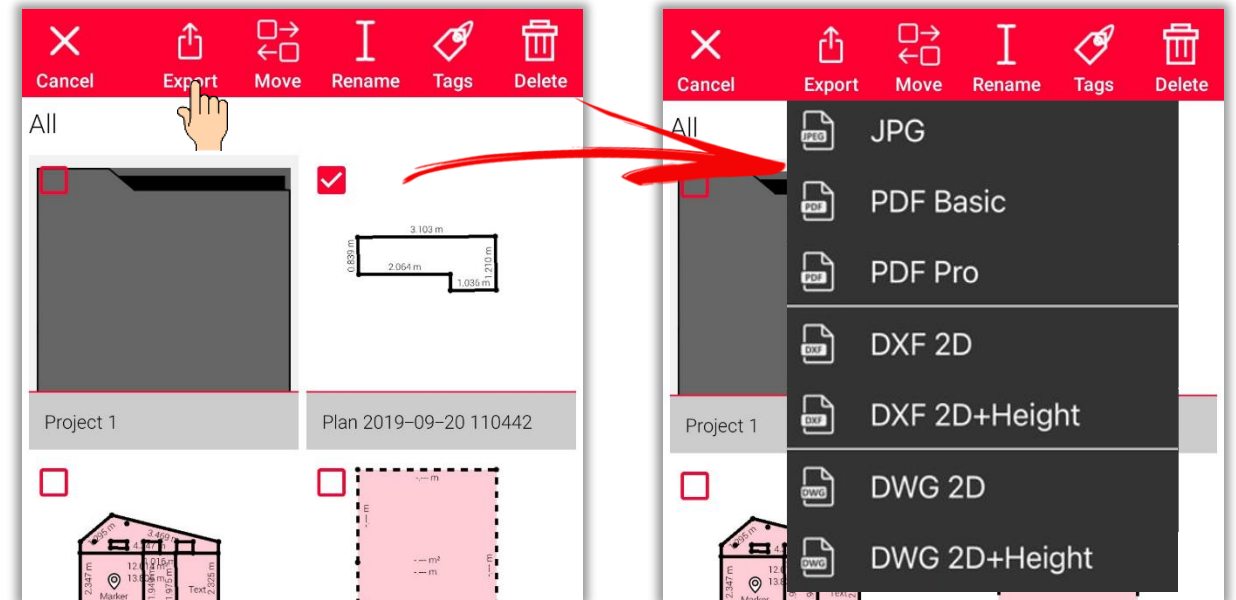

# Organiser and Export

## Organiser – Export

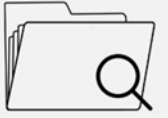

Organiser

- **Sketch on Photo** sketches can be exported in the following formats:
  - JPG
  - PDF Basic
  - PDF Pro
- **Plans** can be exported in the following formats:
  - JPG
  - PDF Basic
  - PDF Pro
  - DXF 2D
  - DXF 2D+Height
  - DXF 3D (only Measure 3D)
  - DWG 2D
  - DWG 2D+Height
  - DWG 3D (only Measure 3D)

- when it has to be **right**

**Leica**  
Geosystems

# Organiser and Export

## Organiser – JPG & PDF Exports



Organiser

JPG

PDF Basic

PDF Pro

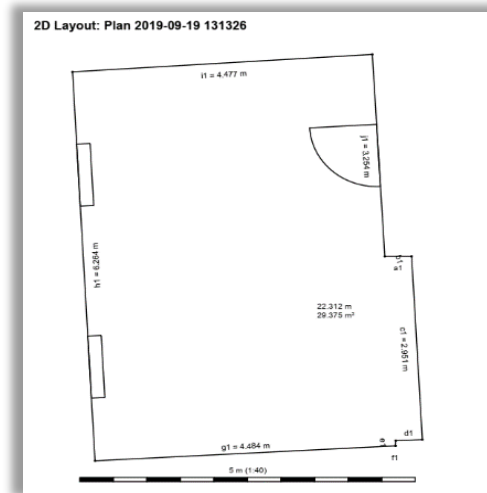
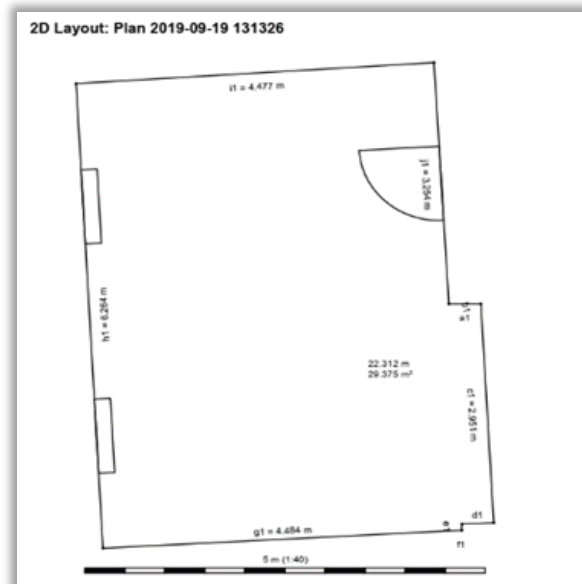
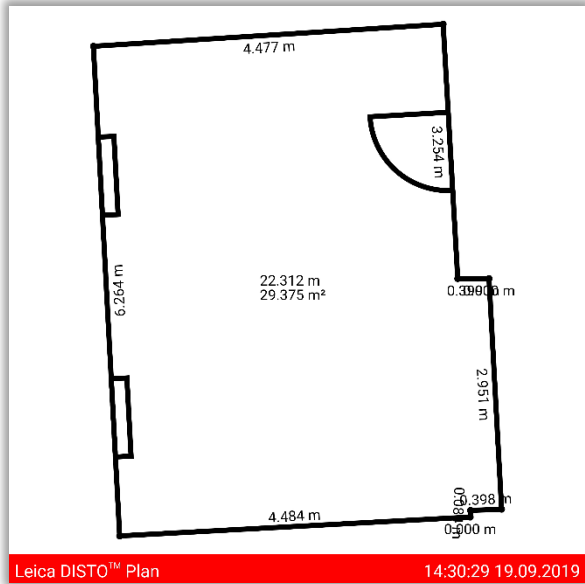

Shape 1

Type	Name	Value	Wall Area	Description
<b>Summary</b>				
	Floor Area	29.375 m <sup>2</sup>	-	-
	Wall Area	66.936 m <sup>2</sup>	-	-
	Opening Area	4.000 m <sup>2</sup>	-	-
	Wall Area Not	62.936 m <sup>2</sup>	-	-
	Volume	88.124 m <sup>3</sup>	-	-
<b>Distance</b>				
	a	0.399 m	-	-
	b	0.000 m	-	-
	c	2.951 m	8.852 m <sup>2</sup>	-
	d	0.398 m	1.194 m <sup>2</sup>	-
	e	0.084 m	-	-
	f	0.000 m	-	-
	g	4.484 m	-	-
	h	6.264 m	-	-
	i	4.477 m	13.431 m <sup>2</sup>	-
	j	3.254 m	9.763 m <sup>2</sup>	-
	Circumference	22.312 m	66.936 m <sup>2</sup>	-
	Height	3.000 m	-	-
<b>Openings</b>				
Door 1 on line j				
	Width	1.000 m	-	-
	Height	2.000 m	-	-

Powered by Leica Geosystems Page 3/4

- when it has to be right



# Organiser and Export

## Organiser – DXF / DWG Exports



Organiser

### 2D

In the **2D** export you can see measurements projected on a 2D plane



### 2D+Height

In the **2D+Height** export you can see 2D plan, extruded with the Room Height

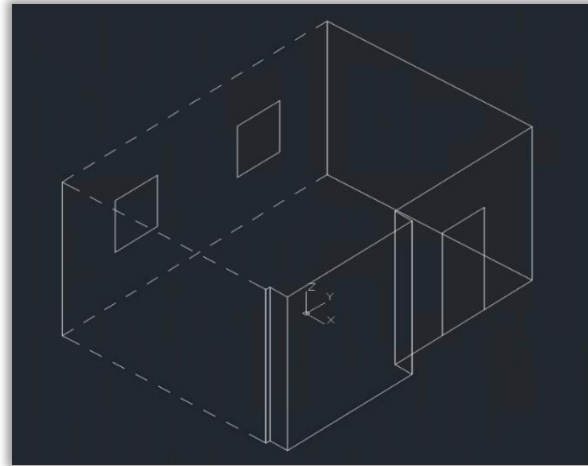

### 3D

In this export, the measurements are presented in the 3D visualization.

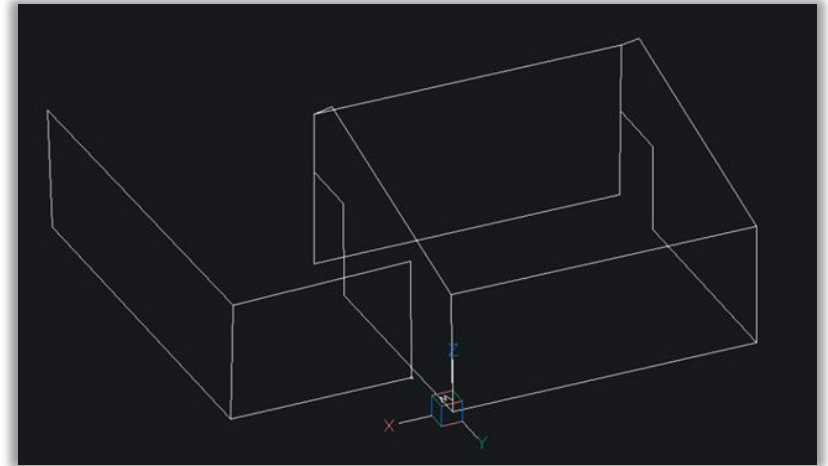

- when it has to be right

**Leica**  
Geosystems

*Leica*  
Geosystems



# DISTO™ Plan App

## Organiser and Export

- when it has to be right

*Leica*  
Geosystems